

FSP3260-6G-E3845

32-inch Industrial IP66 Waterproof Stainless Steel Panel PC

Features

- 32" TFT LCD panel PC with Resolution up to 1920 x 1080
- Built-in Intel® Atom Processor, Celeron, Core i3/i5 Processor is Available for Option
- IP66/NEMA4X Waterproof, Stainless Steel Housing
- 1500nits/2500nits High Brightness for Sunlight Readable (Optional)
Surface Liquid Crystal Support Wide Temperature -20~+110°C



SPECIFICATION

Display	Size/Panel Type	32" TFT LCD Panel
	Resolution	1920 x 1080
	Brightness (cd/m ²)	500cd/m ² (Optional: 1500cd/m ² / 2500cd/m ²)
	Contrast Ratio	3000:1
	Response Time	8ms
	Backlight	LED backlight unit
	Colors	16.7M Colors
	Viewing Angle (H/V)	178°/178°
Cover Lens	Surface Hardness	7H, AR Glass
Touch Screen (Optional)	Touch Screen Type	P-CAP Touch / IR Touch (Optional)
	Surface Hardness	7H
Environment	Operating Temperature	0°~50°C
	Storage Temperature	-20°C ~ +60°C
	Humidity	10%~90% RH(Non-Condensing)
	Waterproof Rating	IP66/NEMA4X, 6 Side Waterproof
Power	Power Input	AC100~240V Input
	Power Consumption	75W
Mechanical	Mounting	VESA Mount 400 x 300mm
	Dimension/Weight	815mm (W) x 506mm (H) x 87mm (D) / 27kgs
	Housing Material / Color	Stainless Steel / Silver
System	Processor/Memory	Intel® Atom™ E3845 Processor / 4GB DDR3L
	I/O Interface	LAN x 1, USB x 1, COM x 1, DC in x 1
	Certification	FCC/CE/RoHS Compliance

Specifications subject to change without notice

ORDERING CODE

FSP3260-6X-XXXX-E3845

G = AR Glass

P = PCAP Touch Screen

I = IR Touch Screen

-H15 = 1500nits High Brightness

-H25 = 2500nits High Brightness

-W = Wide Temperature, -20°~+50°C

ACCESSORIES

- LAN Cable x 1 (5M)
- RS232 Cable x 1 (5M)
- Power Cable x 1 (5M)

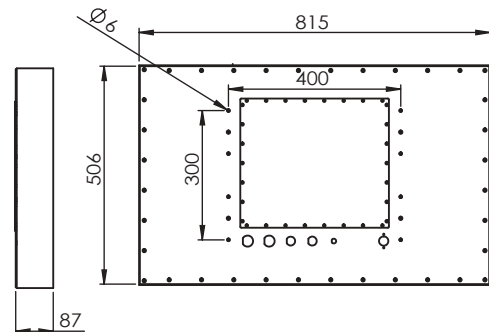
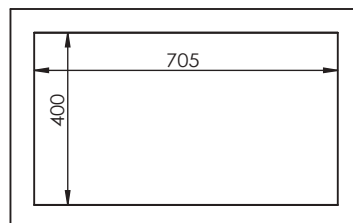

Unit:mm